

FOR LEASE

2,385 Sq. Ft. Street Frontage Unit

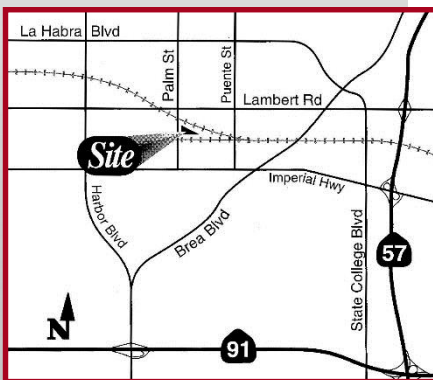

**310 N. Palm Street, Ste. C, Brea
Palm Commerce Centre**



Features Include:

- 452 Sq. Ft. Office Space
- Reception and 1 Private Office
- 100 Amp 3-Phase Power – 120/208 Volt
- One 12'x12' Ground Level Loading Door
- 14' Warehouse Clearance
- Fire Sprinklers
- HUGE Drive Between Buildings
- Street Frontage & Signage
- High Image Project



**1241 N. Lakeview Avenue, Ste. F
Anaheim, CA 92807**

DRE #01033833

www.prpropertiesinc.com

For Further Information Please Contact:

BRIAN DALTON

bdalton@prpropertiesinc.com

DRE #01181724

(714)777-1468 Fax (714)777-5779

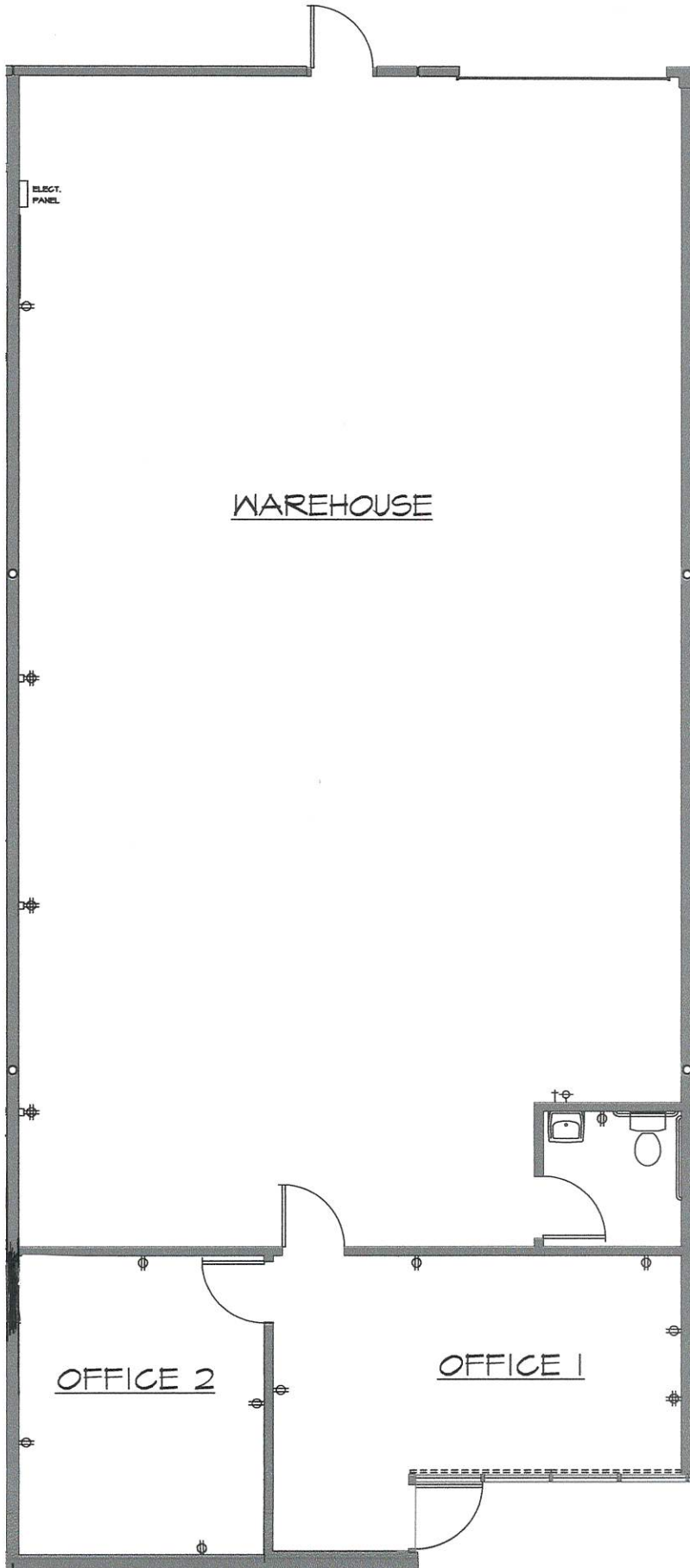

PALM COMMERCE CENTRE
310 N. PALM ST. SUITE C
BREA, CA

OFFICE SPACE: 452 SQ. FT.
TOTAL SPACE: 2385 SQ. FT.

SCALE: $\frac{1}{8}$ " = 1'